



ROSSETT DRIVE
DAVYHULME

£260,000

 2 BEDROOMS

 1 BATHROOM

 1 RECEPTION

 EPC GRADE:- TBC



VITALSPACE
INDEPENDENT ESTATE AGENTS



Rossett Drive, Davyhulme, M41 8DY

****VIDEO TOUR** - **IDEAL FIRST PURCHASE** - VITALSPACE**
ESTATE AGENTS are delighted to bring to the market this exceptionally well presented TWO BEDROOM semi-detached property, located in a sought-after residential area nestled between both Davyhulme Road and Woodhouse Road. This property offers a thoughtfully designed accommodation, featuring an entrance porch, a generously sized living room alongside a spacious modern dining kitchen. The kitchen itself is fitted with an array of contemporary high gloss wall and base units and provides ample space for a dining table and chairs, perfect for everyday living and entertaining. Stairs rise to the first floor where two generously sized bedrooms can be found and a contemporary three-piece tiled shower room. Externally, the front of the property boasts a shaped garden with alongside a driveway that offers excellent off road parking. To the rear, there is a beautifully landscaped, low maintenance garden with a seating area, perfect for enjoying outdoor dining or relaxation during those summer months. Conveniently situated close to well regarded schools, local amenities, excellent transport links and within easy reach of Urmston Retail Park, the M60, and M62. Contact VitalSpace Estate Agents today to arrange an internal viewing and discover everything this stunning home has to offer.





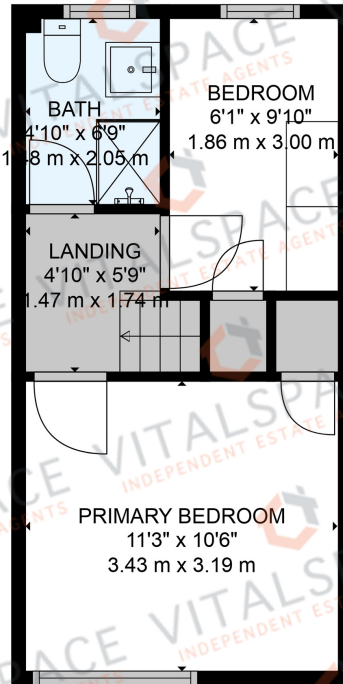
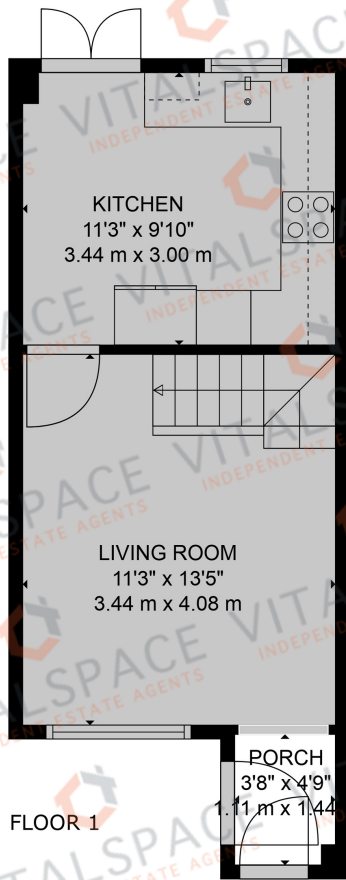

Features

- Two bedrooms
- Semi detached property
- Gas central heating
- Ideal first time purchase
- uPVC double glazing
- Modern dining kitchen
- Driveway and gardens
- Quiet Davyhulme location
- Well presented
- Viewing essential

Frequently Asked Questions

Tenure: Leasehold with 979 years remaining and Ground Rent of £16.50 per Quarter.

How long have the vendors owned the property?
18 Years

When was the boiler last serviced? September 2024

Why is the vendor moving? Moving closer to the coast.

If you would like to submit an offer on this property, please visit our website - www.vitalspace.co.uk/offer - and complete our online offer form.

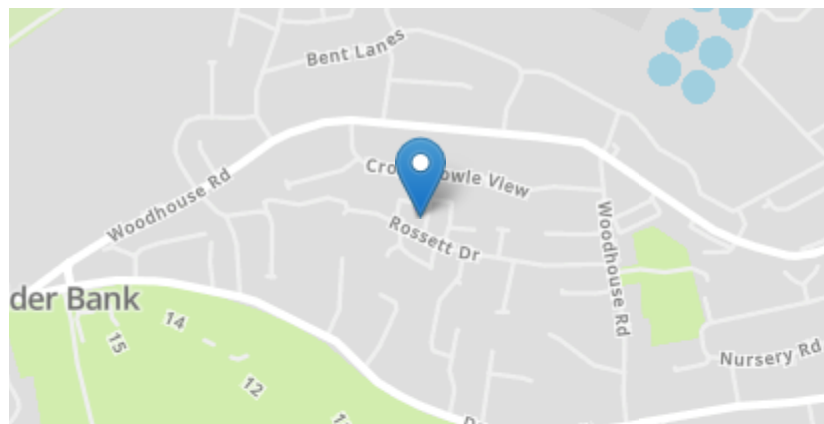

VitalSpace and their clients give notice that: 1 They have no authority to make or give any representations or warranties in relation to the property. These particulars do not form part of any offer or contract and must not be relied upon as statements or representations of fact. 2 Any areas, measurements are approximate. The text, photographs and plans are for guidance only and are not necessarily comprehensive. It should not be assumed that the property has all necessary planning, building regulations or other consents and VitalSpace have not tested any services, equipment or facilities. Purchasers must satisfy themselves by inspection or otherwise.